

INSTALLATION INSTRUCTIONS

Product	Dimensions	Click Type	Locking System Description
Amor Classic / Astoria	1200 x 190 x 8mm	Unilin Unifit™	Fold Down + Side Tap
Legacy	1261x 192 x 8mm	Uniclic®	Angle-Angle
Belle Endless	1216 x 197 x 8mm	Unilin ClickXpress™	Angle-Angle
Belle XL / Elegant XL / Henley XL	2050 x 240 x 8mm	Unilin FitXpress™	Fold Down
Vista / Integral / Enchantment	1216 x 197 x 8mm	2G Fold Down	Fold Down
Longreach / Malanda	2260 x 166 x 12mm	2G Fold Down	Fold Down
Atherton / Undara	1215 x 166 x 8mm	2G Fold Down	Fold Down

Godfrey Hirst recommends installation be carried out by a professional flooring installer.

WARNING - Prior to any take-up or removal of floorcoverings, adhesives or underlay, you should be certain these do not contain asbestos. If it is known or suspected the previous flooring, adhesive or underlay contains asbestos, you should avoid creating dust and the previous flooring and/or components should only be removed by an appropriately licenced asbestos removal contractor.

GENERAL

1. Inspect product in good lighting conditions to ensure it is correct (colour, quality and quantity) as ordered. Open boxes cannot be returned. Godfrey Hirst laminate flooring is for interior use only.
2. Note locking systems listed above.
3. Ensure conditions of product and site are in balance before, during and after installation. The product must be acclimatised in the installation area for at least 24-48 hours in unopened packs at temperature between 18-27°C and a relative humidity between 35-75%. This temperature and humidity range is to be maintained before, during and after installation. Packs should not be opened until the day of installation to avoid moisture pickup.
4. Subfloor must be solid, level (2mm over 1000mm), dry (75% or less relative humidity) and clean. Do not install over existing floor coverings as any such installation may void warranty.
5. Use a recognised 2mm moisture barrier underlay and completely tape all joints with moisture resistant tape. Run underlay at least 50-100mm up all vertical surfaces and trim back after installation. (These are the single most important steps to a good installation and a great performing floor).
6. Minimum 10mm expansion gaps to be provided at all fixed vertical surfaces (including around cabinetry, island benches and all fixed furniture).
7. Check each board for visual defects and locking system integrity in optimal lighting before and during installation. Clean any debris out of locks before installation. Always use boards from several packs and inspect each board to get the best balanced visual installation. Never install defective product. Installation is recognised as acceptance of all visual defects.
8. When cutting boards during installation, cut décor face up with a hand saw and/or cut décor face down with a power saw. If cutting boards using any type of saw, dust extraction and/or respiratory protection must be used.

9. Skirting boards or Godfrey Hirst scotia and/or end caps will be needed to cover the perimeter expansion gap. Alternately, the skirting boards can be undercut. Fixings should be to the wall only, never directly to the floor. Silicone or caulking compound is not recommended. Godfrey Hirst has accessories to match/complement the laminate flooring.
10. Minimum width of boards for first and last rows is 40mm. End stagger of joints in rows should be minimum 300mm.
11. Ensure that the first 3-4 rows are checked for straightness using a string line. Continue to check for straightness at all stages of the installation.
12. Internal expansion breaks to be provided at doorways, thresholds and open areas exceeding 10mx10m.

WATER RESISTANT PRODUCTS ONLY (AMOR CLASSIC)

To achieve moisture resistance for installations into wet areas this requires the area to be isolated with an internal expansion break at the doorway/threshold then expansion gaps in wet areas only to be filled with 5mm foam and flexible, mould resistant silicone. Free standing bathtubs should never be installed on a water resistant laminate floor as it needs to float.

Please note:

1. Many problems with floating floors relate to excessive moisture. Ensure sub floor is totally dry (75% or less relative humidity) and the moisture barrier and underlay are correctly installed and completely taped.
2. Do not install laminate flooring outdoors, wet rooms with floor wastes, hair dressing salons or other high moisture or humid areas. Other than product carrying a Water Resistance Warranty, laminate flooring should not be installed in wet areas such as bathrooms, toilets and laundries.

- Laminate floors must be installed using a floating floor system – they need to be able to move. Ensure expansion gaps allow for movement, and furniture items exceeding 200kg are not placed on the floor.
- Insufficient expansion gaps, including in doorways and under trims, will cause a floor to potentially buckle, peak, cup, and/or separate, leading in most cases to floor failure.
- Godfrey Hirst laminate flooring should never be installed over any electrical radiant heating system - the speed of sudden temperature changes having the potential to negatively affect the floor. Godfrey Hirst laminate flooring may, if properly installed, be installed over hydronic underfloor radiant heating systems. Please contact Godfrey Hirst for detailed installation instructions.
- Uneven subfloors can cause the locking system to break and/or the floor to sound drummy, or become noisy, and will cause early deterioration and/or failure of the floor.
- Care and Maintenance Instructions must be followed to maintain the product warranty. Please ensure these instructions are left with the occupier.

DETAILED DRAWINGS

- Perform preparation works including (but not limited to) any levelling, undercutting of door jambs and/or skirting boards and correctly install the underlay and fully tape the joints.
- Laminate floors are normally installed adjacent the longest run where possible. Plan your installation, refer to note 7 below, which may necessitate trimming the first row.
- Start in the left corner, install the first row. Leave a minimum expansion gap of 10mm at ends and sides.

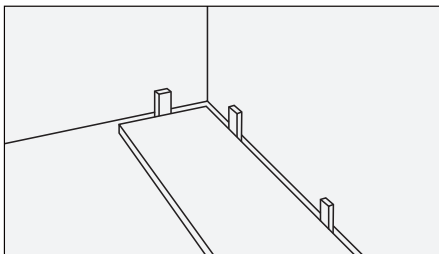

4. Install the second row:

Use the off-cut from the first row to start the second row. It must be >300mm, and not closer than 300mm from the end join in the previous row.

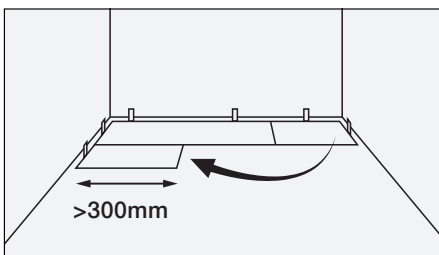

Locking System Fold Down:

Long side first, then fold down.

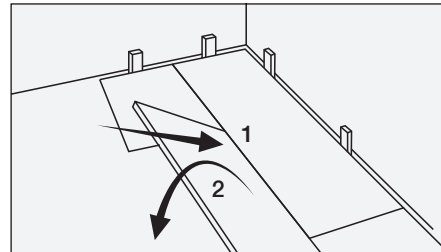

Locking System Angle-Angle:

Short side first, then slide in.

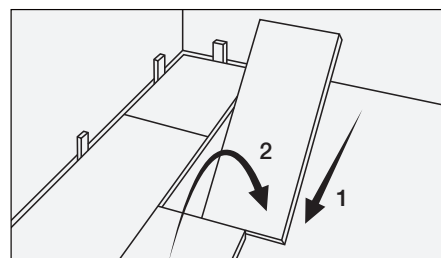

Always tap the long joint with a tapping block to ensure complete engagement. Never strike the floor directly as this will damage the locking system – always use a block.

- Continue laying the floor. Place wedges/packers to ensure the minimum 10mm expansion gap is respected. Always tap the long joint with a tapping block.
- At doorways, trim the male part of the end click on Fold Down products so the board can slide under the architrave. Use a crosslinking PVA glue for the trimmed joint, engage the long side of the board and use a tapping block to engage the short end of the board. Unilin Unifit™ products can be side-tapped.

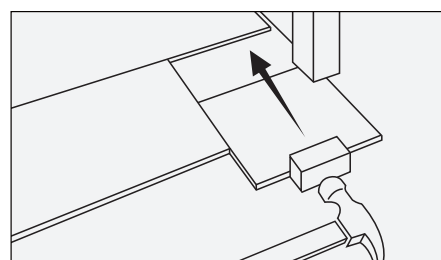

- The final row must be a minimum 40mm in width. Glue the last rows end joints with PVA glue if not able to side-tap.

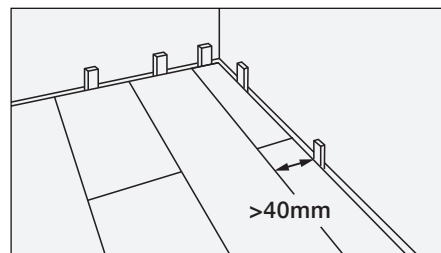

8. Internal expansion breaks are required at doorways/thresholds and rooms exceeding 10mx10m.
9. Remove spacers/wedges from around the room and install skirting boards and/or Godfrey Hirst scotia and/or finishing trims (in

accordance with Godfrey Hirst accessories installation guidelines). Never fix any trims directly to the floor and ensure fixing does not compromise expansion gaps. Silicone or caulking compound is not recommended.

CARE & MAINTENANCE

Congratulations on selecting a quality floor designed with easy care and maintenance in mind. To help enjoy the longevity of your floor for many years to come, follow these simple steps:

CLEANING & CARE

1. **Immediately** – clean up any liquid or water based spills or any other potentially staining marks using a dry clean cloth. Amor Classic has a 72 hour spill resistance surface, but don't leave liquid/water based spills there just to test it. Godfrey Hirst floors are resistant to most spots and stains, however some materials or colourants (such as tar, grease, oil, dyes, waxes, ball point, marker pens, pet mishaps or foods/beverages containing strong dyes as mustard, curry, cordial, coffee, tea etc.) may under certain conditions migrate into the wear layer causing indelible stains.
2. **Daily** or as required – remove any loose dirt or grit which could damage the floor by sweeping with a soft dry broom or vacuum (preferably with an effective dust filter and suction nozzle for hard surfaces turning off a powerhead, if installed).
3. **Weekly** – clean using a waterless laminate floor cleaning fluid and micro fibre mop, or a well rung out damp mop (the floor should be dry 15 seconds after mopping) and a non-abrasive soap-free PH neutral cleaner suitable for laminate floors to remove any footprints, dirt and other stains or marks. Never flood the floor with water as excessive moisture can damage the floor.
4. **As required** – stubborn scuffs and stains can easily be removed using a damp cloth or sponge with a diluted solution of methylated spirits. Ensure the methylated spirits is completely rinsed from the flooring.
5. Never use a steam-mop or steam-cleaner.
6. Never use abrasive cleaners, nylon scouring pads, steel wool, scouring powder or bleach as they may damage the floor.
7. Never use oil, soap, wax or polishes as these finishes may make the floor slippery and can leave a dull finish on the floor.
8. Place entrance mats (which must not have a rubber backing) at all external doors to trap dirt, sand, grit, moisture and other substances from shoes:
 - a. Double entrance mats are required for residential installations – 1 coarse external mat, and 1 medium internal mat.
 - b. Triple commercial mats with a minimum walk off zone of 3.5 metres are required for commercial installations – refer to mat manufacturer.
Mats must be cleaned regularly.

9. Use non-staining felt protectors under heavy pieces of furniture. Fit office chairs, filing trolleys, mobile containers and old hard or sharp edged castors on furniture with soft treads or castors. Chair pads should be used under desk chairs with castors.
10. Heavy objects and furniture such as large bookcases, full sized billiard tables or kitchen units should not be situated on any floating installation. This can lead to the floor failing to respond to contraction and expansion, which can cause squeaking, gapping and possible failure.
11. Never drag, slide or roll furniture or appliances across your floor. Protect the surface if using a trolley to move heavy objects.
12. Floor to ceiling windows coupled with the Australian/New Zealand sun can create floor surface temperatures over 70°C. Your floor should be protected from extreme temperatures and strong direct sunlight by the use of interior temperature and humidity control (recommended temperatures 10-30°C and relative humidity levels between 30% and 70%), window tinting, awnings and/or curtains/blinds. Dramatic temperature changes and/or extreme humidity can cause joints to lip/gap and prolonged direct sunlight will cause fading.
13. Pet claws can scratch the flooring. Keep nails trimmed.
14. Spiked heels or shoes in need of repair can severely damage your floor. In areas of excessive traffic and wear, make use of runners or area rugs. Rugs should be cleaned regularly.

MAINTENANCE

1. Laminate floors are maintained by the above CLEANING & CARE instructions.
2. Laminate floors cannot be sanded.

Commercial Installations - Additional maintenance may be required for commercial installations. A copy of the Godfrey Hirst Commercial Cleaning and Maintenance Guide is available at <https://www.godfreyhirst.com/au/commercial/technical>.